

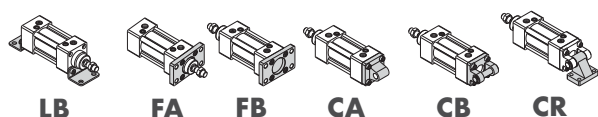

### Articulaciones para Cilindro



### Tipos de Montaje



### Fuerza de Trabajo

Unidad: Newton(N)

Ø Cilindro (mm)	Ø Vástago (mm)	Tipo de Accionamiento	Área de Émbolo (mm <sup>2</sup> )	Presión de Trabajo (MPa)									
				0.1	0.2	0.3	0.4	0.5	0.6	0.7	0.8	0.9	
32	12	Doble Efecto	Avance	804	80.4	160.8	241.2	321.6	402.0	482.4	562.8	643.2	723.6
		Retorno	690	69.0	138.0	207.0	276.0	345.0	414.0	483.0	552.0	621.0	
40	16	Doble Efecto	Avance	1256	125.6	251.2	376.8	502.4	628.0	753.6	879.2	1002.4	1130.4
		Retorno	1055	105.5	211.0	316.5	422.0	527.5	633.0	738.5	844.0	949.5	
50	20	Doble Efecto	Avance	1963	196.3	392.6	588.9	785.2	981.5	1177.8	1374.1	1570.4	1766.7
		Retorno	1649	164.9	329.8	494.7	659.6	824.5	989.4	1154.3	1399.2	1484.1	
63	20	Doble Efecto	Avance	3117	311.7	623.4	935.1	1246.8	1558.5	1870.2	2181.9	2493.6	2805.3
		Retorno	2803	280.3	560.6	840.9	1121.2	1401.5	1681.8	1962.1	2242.4	2522.7	
80	25	Doble Efecto	Avance	5026	502.6	1005.2	1507.8	2010.4	2513.0	3015.6	3518.2	4020.8	4523.4
		Retorno	4536	453.6	907.2	1360.8	1814.4	2268.0	2721.6	3175.2	3628.8	4082.4	
100	25	Doble Efecto	Avance	7853	785.3	1570.6	2355.9	3141.2	3926.5	4711.8	4288.2	6282.4	7067.7
		Retorno	7362	736.2	1472.4	2208.6	2948.6	3681.0	4417.2	5153.4	5889.6	6625.8	
125	32	Doble Efecto	Avance	12272	1227.2	2454.4	3681.6	4908.8	6136.0	7363.2	8590.4	9817.6	11044.8
		Retorno	11468	1146.8	2293.6	3440.4	4587.2	5734.0	6880.8	8027.6	9174.4	10321.2	
160	40	Doble Efecto	Avance	20106	2010.6	4021.2	6031.8	8042.4	10053.0	12063.6	14074.2	16084.8	18095.4
		Retorno	18849	1884.9	3769.8	5654.7	7539.6	9424.5	11309.4	13194.3	15079.2	16964.1	
200	40	Doble Efecto	Avance	31416	3141.6	6283.2	9424.8	12566.4	15708.0	18849.6	21991.2	25132.8	28274.4
		Retorno	30157	3015.7	6031.4	9047.1	12062.8	15078.5	18094.2	21109.9	24125.6	27141.3	



### Especificaciones SAI

Ø Cilindro (mm)	32	40	50	63	80	100	125	160	200
Tipo de Accionamiento	Doble Efecto								
Fluido	Aire (filtrado a 40 µm)								
Tipo de Montaje	SAI	Básico: FA FB CA CB CR LB TC FTC TCM1 TCM2							
	SAID SAIJ	Básico: FA LB TC FTC TCM1 TCM2							
Presión de Trabajo	0.15 - 1.0 MPa (22 - 145 psi) (1.5 - 10.0 bar)								
Presión de Prueba	1.5 MPa (215 psi) (15 bar)								
Temperatura °C	-20 a 70								
Velocidad mm/s	30 - 800						30 - 500		
Tolerancia de Carrera	0 - 250 <sup>+1.0</sup> <sub>0</sub> 251 - 1000 <sup>+1.5</sup> <sub>0</sub> 1001 - 1500 <sup>+2.0</sup> <sub>0</sub>								
Tipo de Amortiguación	Amortiguación Variable								
Carrera de amortiguación ajustable	27	30	36	40	50				
Tamaño de Puerto	1/8"	1/4"	3/8"	1/2"	3/4"				
TPU Sellos Normal -5 a 80 °C									
NBR Sellos Viton Maximo 180 °C (Recomendado Hasta 120 °C)									

### Simbología

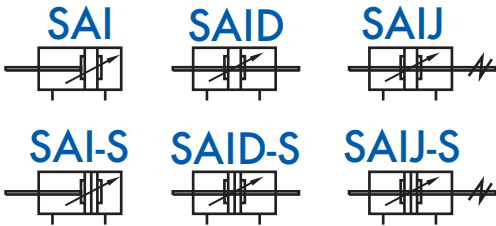

### Cómo Ordenar

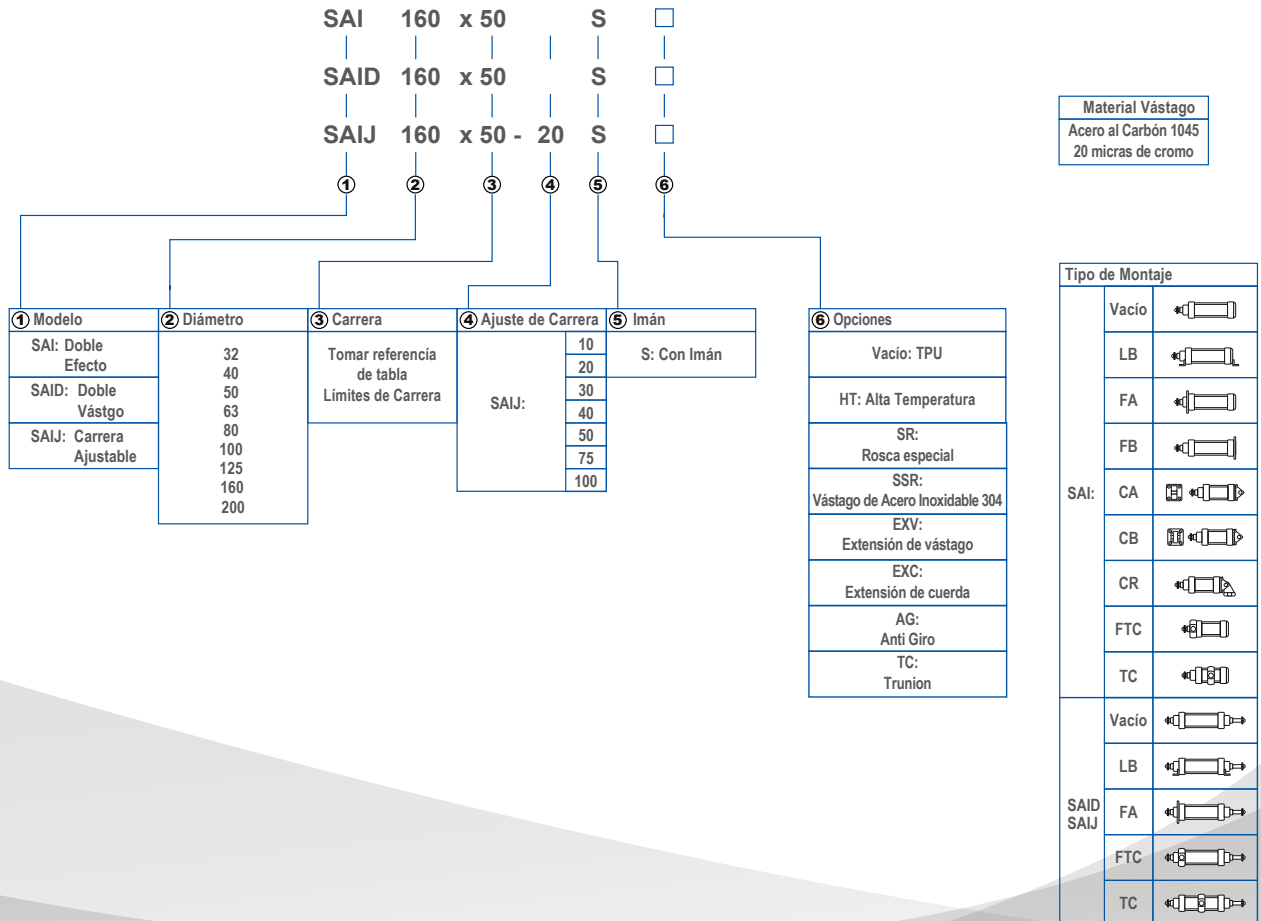

### Límites de Carrera

Ø Cilindro (mm)	Carrera Estándar (mm)																			Máxima Carrera Estándar	Máxima Carrera		
	25	50	75	80	100	125	150	160	175	200	250	300	350	400	450	500	600	700	800			900	1000
32	25	50	75	80	100	125	150	160	175	200	250	300	350	400	450	500						1000	1800
40	25	50	75	80	100	125	150	160	175	200	250	300	350	400	450	500	600	700	800			1200	1800
50	25	50	75	80	100	125	150	160	175	200	250	300	350	400	450	500	600	700	800	900	1000	1200	1800
63	25	50	75	80	100	125	150	160	175	200	250	300	350	400	450	500	600	700	800	900	1000	1500	1800
80	25	50	75	80	100	125	150	160	175	200	250	300	350	400	450	500	600	700	800	900	1000	1500	1800
100	25	50	75	80	100	125	150	160	175	200	250	300	350	400	450	500	600	700	800	900	1000	1500	1800
125	25	50	75	80	100	125	150	160	175	200	250	300	350	400	450	500	600	700	800	900	1000	1500	1800
160	25	50	75	80	100	125	150	160	175	200	250	300	350	400	450	500	600	700	800	900	1000	1500	2000
200	25	50	75	80	100	125	150	160	175	200	250	300	350	400	450	500	600	700	800	900	1000	1500	2000

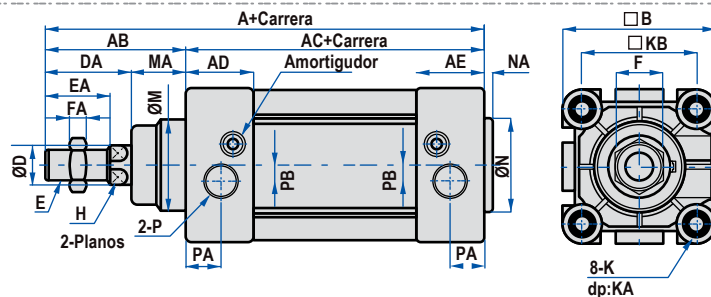

### Dimensiones SAI

Ø Cilindro (mm)	A	AB	AC	AD	AE	B	D	DA	E	EA	F	FA	H	K	KA	KB	M	MA	NA	N	P	PA	PB
32	142	48	94	27.5	27.5	47	12	29	M10 x 1.25	22	17	6	10	M6 x 1	16	32.5	30	19	3	30	1/8"	13	5.5
40	159	54	105	32	32	53	16	33	M12 x 1.25	24	17	7	13	M6 x 1	17	38	35	21	3.5	35	1/4"	17	6
50	175	69	106	31	31	65	20	42	M16 x 1.5	32	23	8	17	M8 x 1.25	17	46.5	40	27	3.5	40	1/4"	15.5	7.5
63	190	69	121	33	33	75	20	42	M16 x 1.5	32	23	8	17	M8 x 1.25	17	56.5	45	27	4	45	3/8"	16.5	7.5
80	214	86	128	33	33	95	25	53	M20 x 1.5	40	26	10	22	M10 x 1.5	19	72	45	33	4	45	3/8"	16.5	9
100	229	91	138	37	37	115	25	55	M20 x 1.5	40	26	10	22	M10 x 1.5	19	89	55	36	4	55	1/2"	18.5	9.5
125	279	119	160	46	46	140	32	74	M27 x 2	54	41	13.5	27	M12 x 1.75	22	110	60	45	4	60	1/2"	23	14
160	332	152	180	50	50	180	40	94	M36 x 2	72	55	18	36	M16 x 1.5	30	140	65	58	4	65	3/4"	25	15
200	347	167	180	50	50	220	40	100	M36 x 2	72	55	18	36	M16 x 1.75	30	175	75	67	5	75	3/4"	25	15

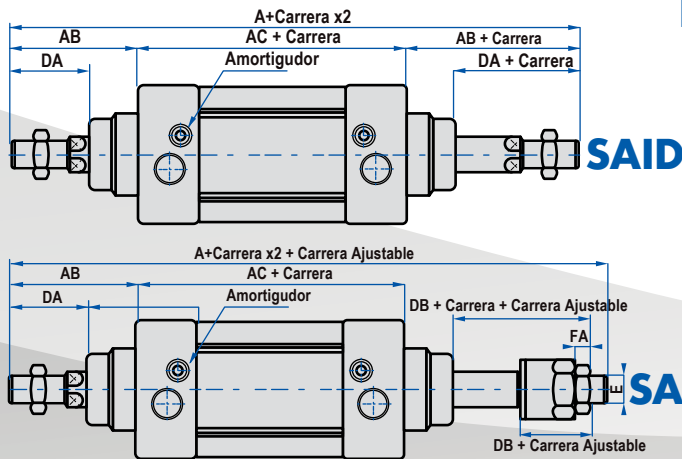

### Dimensiones SAID Doble Vástago SAIJ Ajuste de Carrera

Ø Cilindro (mm)	A		AB	AC	DA	DB	E	FA
	SAID	SAIJ						
32	190	188	48	94	29	27	M10X1.25	6
40	213	208	54	105	33	28	M12X1.25	7
50	244	231	69	106	42	29	M16X1.5	8
63	259	246	69	121	42	29	M16X1.5	8
80	300	282.5	86	128	53	35.5	M20X1.5	10
100	320	300.5	91	138	55	35.5	M20X1.5	10
125	398	366.5	119	160	74	42.5	M27X2.0	13.5
160	484	458	152	180	94	68	M36X2.0	18
200	514	482	167	180	100	68	M36X2.0	18

## Montajes

**LB**

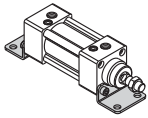

**FA**

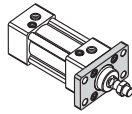

**FB**

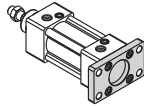

**CA**

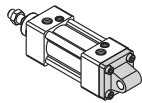

**CB**

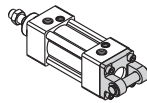

**CR**

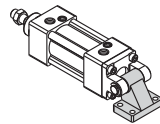

## Códigos de Accesorios Montajes

Ø Cilindro (mm)	Accesorios de Montaje				
	LB	FA / FB	CA	CB	CR
32	F-SI32LB	F-SI32FA	F-SE32CA	F-SE32CB	F-SI32CR
40	F-SI40LB	F-SI40FA	F-SE40CA	F-SE40CB	F-SI40CR
50	F-SI50LB	F-SI50FA	F-SE50CA	F-SE50CB	F-SI50CR
63	F-SI63LB	F-SI63FA	F-SE63CA	F-SE63CB	F-SI63CR
80	F-SI80LB	F-SI80FA	F-SE80CA	F-SE80CB	F-SI80CR
100	F-SI100LB	F-SI100FA	F-SE100CA	F-SE100CB	F-SI100CR
125	F-SI125LB	F-SI125FA	F-SE125CA	F-SE125CB	F-SI125CR
160	F-SI160LB	F-SI160FA	F-SI160CA	F-SI160CB	F-SI160CR
200	F-SI200LB	F-SI200FA	F-SI200CA	F-SI200CB	F-SI200CR

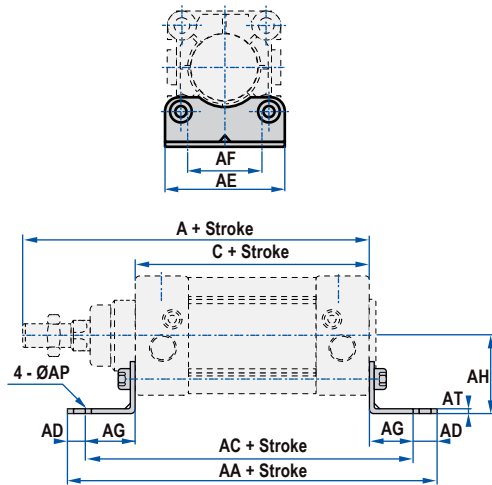

### Dimensiones LB

Ø Cilindro (mm)	A	C	AA	AC	AD	AE	AF	AG	AH	AP	AT
32	142	94	158	142	8	47	32	24	32	7	3
40	159	105	179	161	9	53	36	28	36	9	3
50	175	106	190	170	10	65	45	32	45	9	3
63	190	121	209	185	12	75	50	32	50	9	3
80	214	128	248	210	19	95	63	41	63	12.5	4
100	229	138	266	220	19	115	75	41	71	14.5	4
125	279	160	290	250	20	140	90	45	90	16.5	8
160	332	180	340	300	20	180	115	60	115	18.5	8
200	347	180	380	320	30	220	135	70	135	24	9

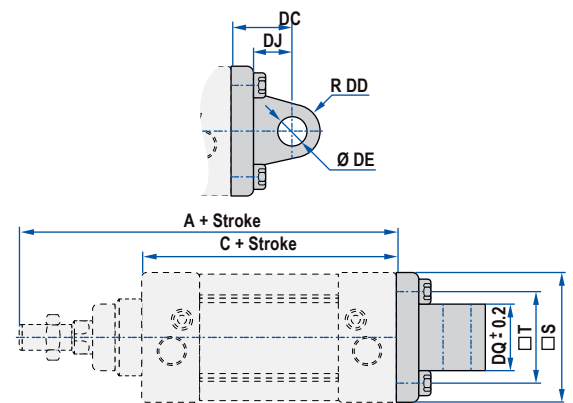

### Dimensiones CA

Ø Cilindro (mm)	A	C	S	T	DC	DD	DE	DJ	DQ
32	142	94	47	32.5	22	9	10	13	25.8
40	159	105	52	38	25	10.5	12	16	27.8
50	175	106	64	46.5	27	11	12	17	31.7
63	190	121	74	56.5	32	13.5	16	22	39.7
80	214	128	94	72	36	14.5	16	22	49.7
100	229	138	113	89	41	17	20	27	59.7
125	279	160	139	110	50	22	25	33	69.7
160	332	180	180	140	55	30	30	35.5	89.7
200	347	180	220	175	60	30	30	37	89.7

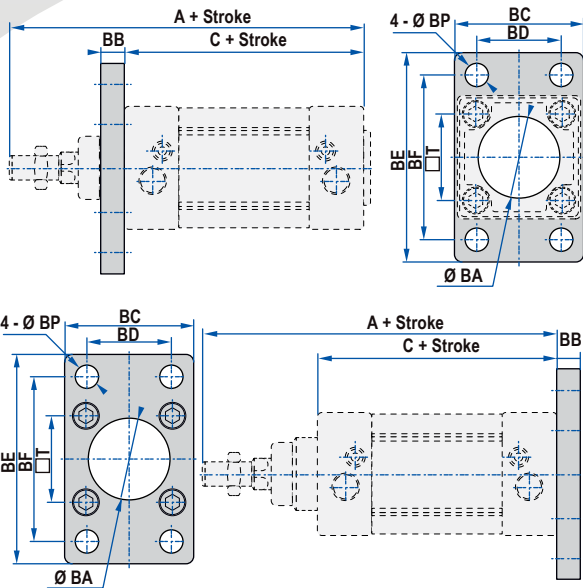

## Dimensiones FA / FB

Ø Cilindro (mm)	A	C	BA	BB	BC	BD	BE	BF	BP	T
32	142	94	30.5	10	47	32	80	64	7	32.5
40	159	105	35.5	10	53	36	90	72	9	38
50	175	106	40.5	12	65	45	108	90	9	46.5
63	190	121	45.5	12	75	50	118	100	9	56.5
80	214	128	45.5	16	95	63	150	126	12.5	72
100	229	138	55.5	16	115	75	176	150	14.5	89
125	279	160	60.5	20	139	90	218	180	16.5	110
160	332	180	65.5	20	180	115	280	230	18.5	140
200	347	180	75.5	25	220	135	320	270	24	175

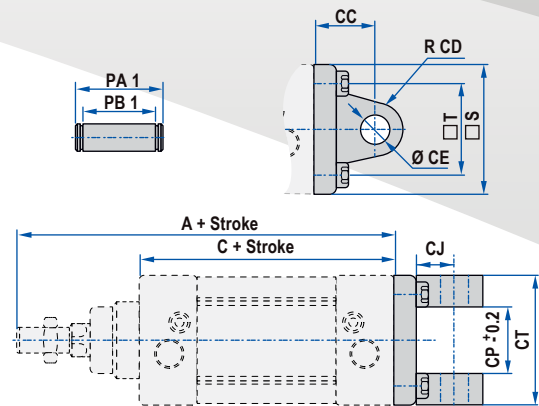

## Dimensiones CB

Ø Cilindro (mm)	A	C	CC	CD	CE	CJ	CP	CT	PA1	PB1	S	T
32	142	94	22	9	10	13	26	45	51	45.5	47	32.5
40	159	105	25	10.5	12	16	28	52	59	52.5	52	38
50	175	106	27	11	12	17	32	60	67	60.5	64	46.5
63	190	121	32	13	16	22	40	70	77	70.5	74	56.5
80	214	128	36	14	16	22	50	90	97	90.5	94	72
100	229	138	41	17.5	20	27	60	110	119	110.5	113	89
125	279	160	50	21.5	25	33	70	130	139	130.5	139	110
160	332	180	55	30	30	35.5	90	170	181	170.5	180	140
200	347	180	60	30	30	36	90	170	181	170.5	220	175

## Dimensiones CR

Ø Cilindro (mm)	A	AA	B	C	CC	CD	CJ	D	E	F	G	H	I	K	L
32	142	32	26	94	10	49	10	21	18	30	8	38	50	6.5	10.5
40	159	36	28	105	12	55	12	24	22	34	10	41	53	6.5	10.5
50	175	45	32	106	12	67	13	33	30	44	12	50	64	9	14
63	190	50	40	121	16	76	17	37	35	49	12	52	66	9	14
80	214	63	50	128	16	92.5	19.5	47	40	59	14	66	85	11	17
100	229	71	60	138	20	105.5	22.5	55	50	69	15	76	95	11	17
125	279	90	70	160	25	134	29	70	60	88	20	94	122	13.5	20
160	332	115	90	180	30	171	25.5	97	88	126	25	118	156	13.5	20
200	347	135	90	180	30	185	31	105	90	130	30	122	162	18	26

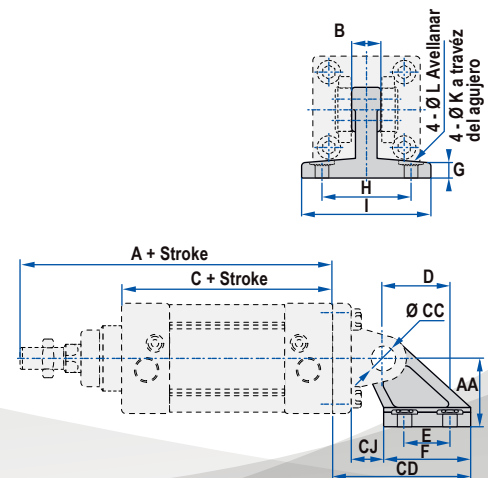

## Articulaciones



**Horquilla I Macho**



**Horquilla Hembra Y**



**Junta Flotante**



**Rótula**

## Códigos de Accesorios Articulaciones para Cilindros

Ø Cilindro (mm)	Horquillas				Sensor Switch	
	I	Y	F	U	CMSE	DMSE
32	F-M10x125I	F-M10x125Y	F-M10x125F	F-M10x125U	CMSE	DMSE
40	F-M12x125I	F-M12x125Y	F-M12x125F	F-M12x125U		
50	F-M16x150I	F-M16x150Y	F-M16x150F	F-M16x150U		
63	F-M16x150I	F-M16x150Y	F-M16x150F	F-M16x150U		
80	F-M20x150I	F-M20x150Y	F-M20x150F	F-M20x150U		
100	F-M20x150I	F-M20x150Y	F-M20x150F	F-M20x150U		
125	F-M27x200I	F-M27x200Y	F-M27x200F	F-M27x200U		
160	F-M36x200I	F-M36x200Y	F-M36x200F	F-M36x200U		
200	F-M36x200I	F-M36x200Y	F-M36x200F	F-M36x200U		

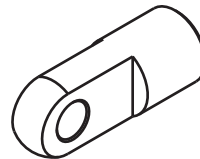

**Horquilla I Macho**

## Cómo Ordenar

**F M16 x 150 I**

① Código Accesorio	② Rosca de Tornillo	③ Paso de Rosca	④ Código
M10	M16	125: 1.25mm	I: Horquilla I Macho
M12			
M16			
M20			
M27	150: 1.5mm		
M36			
M42			
		200: 2.0mm	

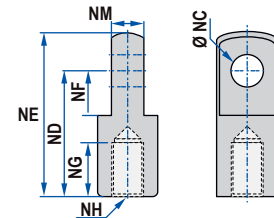

## Dimensiones

Item	NC	ND	NE	NF	NG	NH	NM
F-M10x125I	10	40	50	15	20	M10x1.25	10
F-M12x125I	12	48	62	24	20	M12x1.25	12
F-M16x150I	16	64	82	32	23	M16x1.5	16
F-M20x150I	20	80	102	40	30	M20x1.5	20
F-M27x200I	30	110	139	51	45	M27x2.0	30
F-M36x200I	35	144	181	65	55	M36x2.0	35

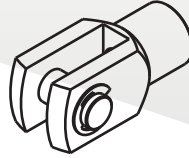

## Horquilla Hembra Y

### Cómo Ordenar

	F	M16	x	150	Y	
	①	②		③	④	
① Código Accesorio	② Rosca de Tornillo		③ Paso de Rosca	④ Código		Y: Horquilla Y Hembra
	M10	125: 1.25mm				
	M12					
	M16					
	M20	150: 1.5mm				
	M27	200: 2.0mm				
	M36					

### Dimensiones

Item	E	G	H	I
F-M10x125Y	M10x1.25	25	10	10

Item	NA	NC	ND	NP	NQ
F-M12x125Y	25.4	12	48	24	62
F-M16x150Y	32	16	64	32	80
F-M20x150Y	44.4	20	80	40	101
F-M27x200Y	54	30	110	55	139
F-M36x200Y	70	35	144	73	179

Item	NM	NH	PA	PB
F-M12x125Y	12	M12x1.25	32.4	26.2
F-M16x150Y	16	M16x1.5	39	32.8
F-M20x150Y	20	M20x1.5	53.4	45.2
F-M27x200Y	30	M27x2.0	64.2	54.8
F-M36x200Y	35	M36x2.0	80.2	70.8

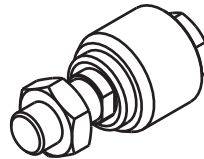
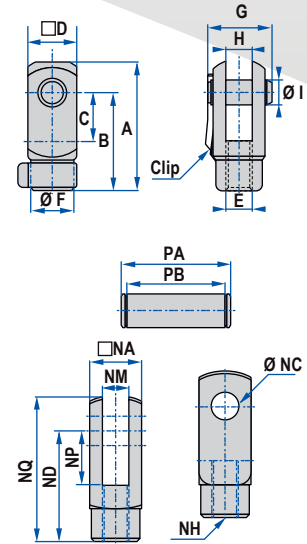

## Junta Flotante F

### Cómo Ordenar

	F	M22	x	150	F	
	①	②		③	④	
① Código Accesorio	② Rosca de Tornillo		③ Paso de Rosca	④ Código		F: Junta Flotante
	M10	125: 1.25mm				
	M12					
	M16					
	M20	150: 1.5mm				
	M27	200: 2.0mm				
	M36					

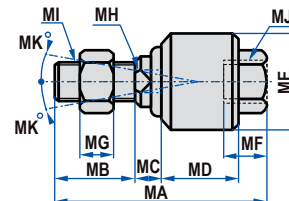

### Dimensiones

Item	MA	MB	MC	MD	ME	MF	MG	MH	MIMJ	MK
F-M10x125F	58	22	7	21	26	11	6	10	M10x1.25	12
F-M12x125F	58	22	8	21	28	11.5	7	12	M12x1.25	12
F-M16x150F	90	27	10	41	44.5	19	8	17	M16x1.5	7
F-M20x125F	102	29	13	46	53	22	10	22	M20x1.5	10
F-M27x200F	136.5	40	14.5	52.5	59.5	40	13.5	27	M27x2.0	5
F-M36x200F	194.5	60	20.5	77.5	84	54	18	36	M36x2.0	5

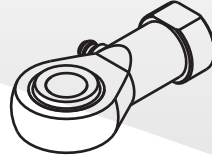

### Rótula U

### Cómo Ordenar

① Código Accesorio	② Rosca de Tornillo	③ Paso de Rosca	④ Código
	F	M10 x 125	U
	①	②	③
	M10	125: 1.25mm	U: Rótula
	M12		
	M16	150: 1.5mm	
	M20		
	M27	200: 2.0mm	
	M36		

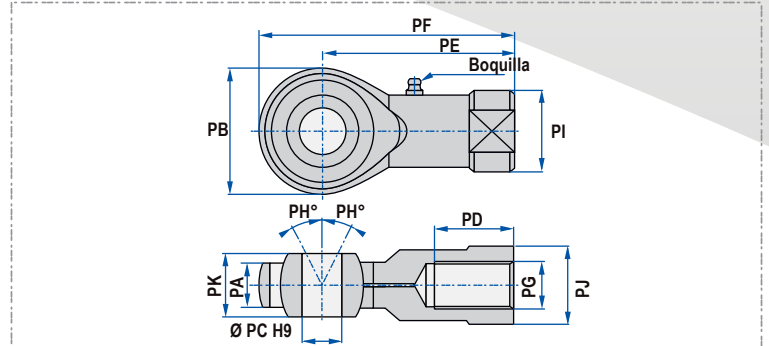

### Dimensiones

Item	PA	PB	PC	PD	PE	PF	PG	PH	PI	PJ	PK
F-M10x125U	11	26	10	20	43	56	M10x1.25	13	19	17	14
F-M12x125U	12	32	12	22	50	66	M12x1.25	13	22	19	16
F-M16x150U	15	40	16	28	64	84	M16x1.5	15	27	22	21
F-M20x150U	18	46	20	33	77	100	M20x1.5	15	34	30	25
F-M27x200U	25	70	30	51	110	145	M27x2.0	15	50	41	37
F-M36x200U	27.5	80	35	56	125	165	M36x2.0	15	57.5	50	43